



GreenTRIP Connect *beta*

Connect.GreenTRIP.org

What is GreenTRIP?

GreenTRIP helps housing developers build low-traffic developments, implementing a suite of proven traffic reduction strategies such as free transit passes for residents, car sharing, and “unbundling” the price of parking from rent. Since 2008, GreenTRIP-certified developments have resulted in \$150 million in cost savings for residents.

What is GreenTRIP Connect?

GreenTRIP Connect is an online tool that allows you to select a parcel of land considered for development, and instantly predict the benefits of locating near transit with reduced parking.

Users can easily see how affordable homes and traffic reduction strategies reduce driving and greenhouse gas emissions, as well as create savings for developers and residents.

The tool is free, and provides information in a clear, accessible format.

TransForm, a transportation advocacy nonprofit, developed GreenTRIP Connect with the Center for Neighborhood Technology.

Since the beta release in July 2016, Connect has been used by over 2,000 people across California.

We are currently seeking sponsors to celebrate the release of Connect with an event in September 2017. Support this innovative tool to achieve sustainable, equitable communities!



- 1 Enter a location
- 2 Pick a parcel
- 3 Describe the project
- 4 Predict driving and greenhouse gas emissions!

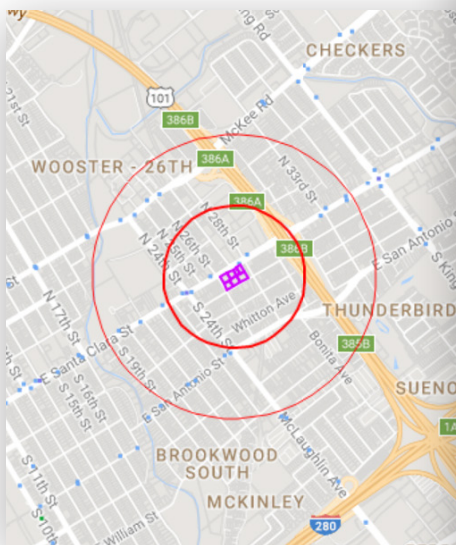

GreenTRIP Connect dashboard for your project

Project characteristics

- Building: 200 units (default)
- Parking proposed: 40 spaces (default)
- Density: 571.43 units/acre
- Parking ratio: 0.20 spaces/unit

GreenTRIP Certification ready? Yes ?

[See requirements](#)

[+] Click to hide details

Comparison snapshot	Driving miles/day	Greenhouse gases kg CO ₂ /day	Parking spaces predicted use
if built in an average location in the County	30.7	16.03	113 ?
Alameda County			
if built on selected parcel	17.98	9.39	0.89
with affordable housing	6.55	3.42	0.58
with GreenTRIP strategies	3.27	1.71	0.07
Your project	3.27	1.71	0.07

\$3,056 Resident savings from selected GreenTRIP strategies per year/household

\$20,000,000 Saved on parking compared to municipal parking requirement of 2.2 spaces/unit, or 440 spaces total.

89% Less driving

27.43 Fewer miles per day

89% Less climate impact

14.32 Fewer kg of CO₂ per day

94% Less parking used

1.06 Fewer parking spaces used

Total driving and climate impact compared to [Alameda County](#) average.

Ways to use GreenTRIP Connect:



Community Members

If you want to see smarter development and less traffic, you now have powerful data and modeling at your fingertips. You can advocate for more traffic reduction strategies and greater affordability, using free data and reports that are easy to print and share.



Residential Developers

Developers of affordable and market rate housing can use Connect to determine how much driving and greenhouse gases can be reduced by project location and design. Connect shows the benefits of providing only as much parking as is really needed. You can also use it to evaluate potential sites for development.



City Staff and Government Officials

Connect can be recommended to developers or incorporated into the development review process. You can also use Connect to engage residents and inform future neighborhood or community planning. The “project report” feature synthesizes useful information at a glance.

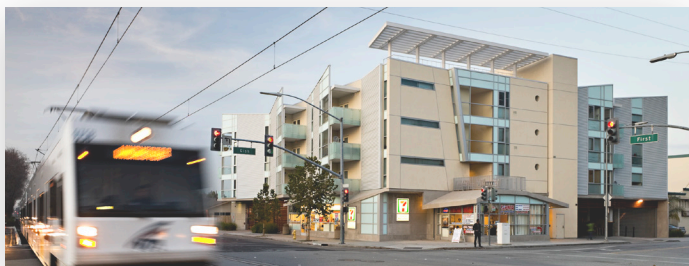

Gish Affordable Apartments, San Jose

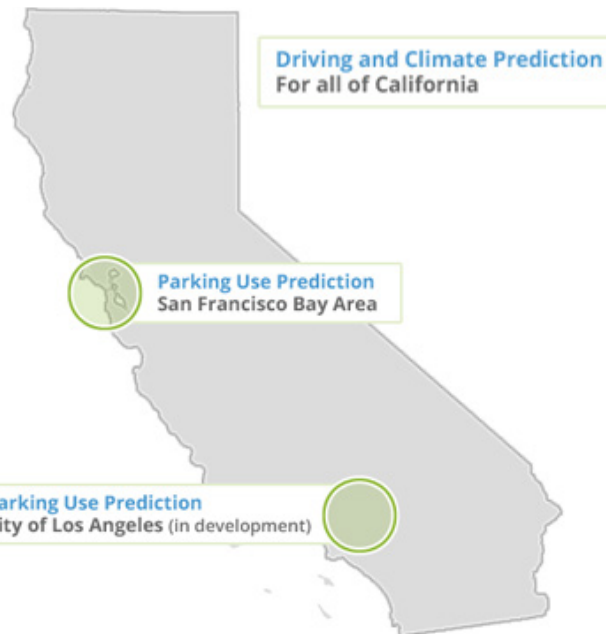

Praise for GreenTRIP...

Sam Liccardo, Mayor of San Jose

“By convening everyone from key stakeholders in our communities to state agency leaders, GreenTRIP Certification and Connect helps San Jose ensure the successful creation of many new affordable, healthy, and safe ways to get to and live in San Jose.”

Barry Swenson, Barry Swenson Builders

“GreenTRIP is the first certification program of its kind that properly rewards density and reduced parking strategies in a way that creates meaningful value for the developer.”

Kate White, California State Transportation Agency

“GreenTRIP not only removes silos between transportation and housing, it creates win-win outcomes: more affordable homes in locations with great transit while improving traffic and our climate.”